



Liquid Courage Watersports
 20917 Shiloh Circle
 Gretna, NE 68028
 Phone: 1-402-690-2341

sales@liquidcouragewatersports.com

Due to production of the rack and advantages to our customers... you will receive your rack in 2 separate boxes that may possibly arrive on separate dates.

1. The actual wakeboard rack, combo rack or ski rack that was ordered.
 - a. You will not use the M-6 socket head screws that come with the rack assembly, nor the tower clamp. You will use the replacement Socket Head Cap screws (the 4 long screws) will be in the Cleat Clamp/Bracket box.
 - b. Shipping this type of rack and direct, allows our customers to have a rack they can easily mount to a tower if they ever purchase a tower and decreases the overall shipping costs to our customers to allow costs to stay as low as possible.
2. The the Cleat Clamp and Bracket (suction cups)to allow it to fasten to the cleat and boat.

Once you receive both packages you are ready to assemble your rack.

ASSEMBLY INSTRUCTIONS (Pages 2-4)

In this Cleat Clamp Box should receive:

1. Upper and lower cleat clamp (with 2 attachment screws, standoff and
2. Suction cup bracket,spacer and suction cups (2)
3. M-6 Socket Head Cap Screws (4) – long screws for suction cup bracket, backplate and rack forks.
4. M-8 Socket Head Cap Screws (4) – shorter to attach bracket to the backplate
5. 2 Allen wrenches for screw types in rack assembly
6. Quick Release Pin with Retainer Ring
7. Parts List

Item	1	Lower Cleat Stand Off
	2	Upper Bracket Stand Off
	3	Upper Cleat Clamp
	4	Rack Base
	5	Lower Cleat Clamp
	6	Suction Cup (2)
	7	Suction Cup Spacer (2)
	8	Bracket
	9	Suction Cup Bracket (2)
	10	M-6 Socket Head Cap Screw (4)
	11	M-8 Socket Head Cap Screw (4)
	12	1/4" x 3/4" Button Head screws (2)

Figure 1

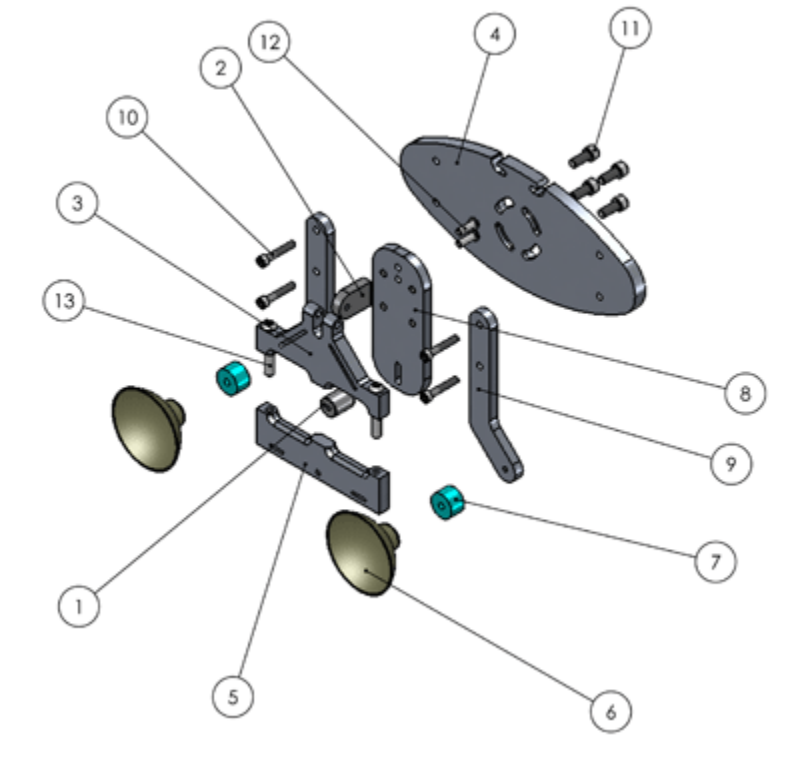

Prior to Installation

- First check the stability and security of your boat cleats.
 - It may be necessary to contact your boat dealer for extra reinforcing under the cleat to allow the rack to be securely attached without causing damage to the boat.
- Select a suitable location for your rack, making sure that it is not placed in the blind spot of the driver.
 - It is best to mount your Overboard Rack the rack on a cleat that is secure, easily accessible, and has a side surface where the suction cups can securely attach. Surface of the boat should be cleaned off with a clean damp cloth and dried prior to attachment.

Assembling the Rack

- **Bracket**
 - Locate the Bracket, Upper Bracket Stand Off, and two $\frac{1}{4}$ " x $\frac{3}{4}$ " button head cap screws. Insert the $\frac{1}{4}$ " x $\frac{3}{4}$ " screws through the bracket (the heads fit into the recessed areas on the bracket). Use hex wrench to tighten until they stop with no greater than a torque of 15 ft lbs..
- **Cleat Clamp**
 - Locate the Upper and Lower Cleat Clamps. (note- the rubber strips are on the back- this will face the boat). Use the $\frac{5}{16}$ " x 2" button head cap screws to attach the upper portion to the lower portion. DO NOT TIGHTEN Yet- this will be tightened when you attach the Cleat Clamp to your cleat on your boat.
 - Insert a $\frac{1}{4}$ " x $\frac{3}{4}$ " button head cap screw (head will be on the back of the Lower Clear Stand Off). Tighten until they stop with no greater than a torque of 15 ft lbs.

- Locate the Lower Cleat Stand Off and thread it onto the front of the Lower Cleat Stand Off. Hand tighten.
- **Rack**
 - Locate the base of the rack (oval), M-8 Socket Head Screws and Bracket (#8 in Fig. 1). Insert the screws through the cut outs on the rack base and into the bracket. The mount allows for leveling, which will be done when you mount the assembly to your boat. If you ordered an Overboard Combo, the M-8 screws will insert from the rear of the bracket (use nylon washer).
 - Locate the Suction Cup Brackets, Suction Cup Spacers (nylon), Suction Cups, and 1/4" x 2" button head screws. Screw the Button Head Cap screws through the threaded hole at the bottom of the bracket (note- the cups need to attach to the boat, so make sure they are properly aligned). Put the nylon spacer on and thread the suction cup onto the threads. Hand Tighten.
 - Locate the Suction Cup Brackets, M-6 socket Head Cap screws (4), and rack forks. Use the screws to mount the Suction Cup Brackets and forks to the rack base, inserting them from the rear of the base (note- the cups should be angled toward the outside of the assembly (see Fig. #1) and aligned so that they can attach to the boat.
 - Make sure the forks are aligned vertically and tighten until they stop with no greater than a torque of 15 ft lbs.

Attaching the Cleat Clamp

- There are 2 possible methods of mounting the Cleat Clamp to your boat depending on the position of your Cleat on the boat.
- Since there are different styles of cleats, we provide two different back cleat pieces. The cleat clamp should tighten down with the completely over the cleat, leaving little to no screw thread showing between the pieces.
- If you have a side mounted cleat, as in Photo #1, your rack will most likely mount with Front Cleat Clamp (A) pointing upwards. *There are however, boats with side mounted cleats, where the rack fits best and the suction cups hold best with the Front Cleat Clamp (A) pointing downwards. This lowers the rack position and may reduce side blind spot.*

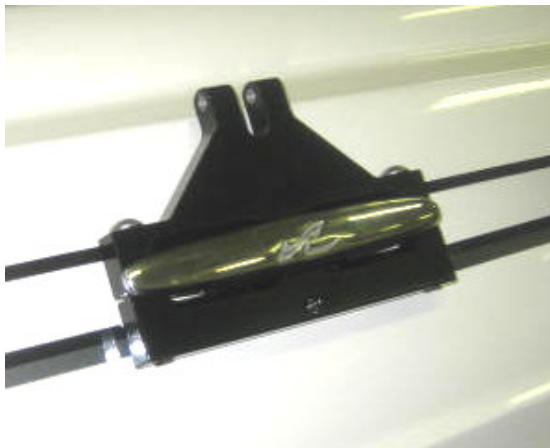

Side Cleat Mount pointing UP



Top Cleat Mount

- If you have a top mounted cleat, as in Photo #2, your rack will most likely mount with the Front Cleat Clamp (A) pointing outwards away from the boat.
- Once you have determined the placement of your Cleat Clamp (depending if it is a side or top mounted cleat), The Upper Cleat Clamp (Figure 1, #3) will line up with the Lower Cleat Clamp (Figure 1, #5) and securely tighten together. With side mount cleats facing upward, the Lower Cleat Stand Off (Figure 1, #1) is will be below the cleat. If you have pop up style cleats, the cleat post may be longer than the clamp is thick. In this case, raise the pop up cleat all the way, and attach the cleat clamp as low as possible on the posts.

Attaching the Rack to the Cleat Clamp and Boat

- To attach the Rack to the Cleat Clamp, line the holes on the Upper Cleat Clamp up with the hole on the upper standoff (see Figure 1) and insert the quick release pin through all 3 holes. The rack base allows adjustment for the rack to be level. When the rack is as level as possible, tighten the 4 Socket Head Cap screws completely, or no greater than 15 lbs. torque.
- Once the pin has been attached (with retainer ring between the Cleat Clamp and Rack Base), lower the rack down onto the boat and make sure there is proper contact with the side of the boat. The cups may not “suction” to the side of the boat- this is acceptable as they are meant to help balance the assembly and not to hold the rack in place. Insert and tighten the knob through the Bracket and into the Lower Cleat Stand Off (Figure 1, #1). The pin and knob will be removed when taking the assembly off.
- For top mounted cleats, the rack will extend over the side of your boat if it is attached as in Photo #4.

Side Mount Cleat

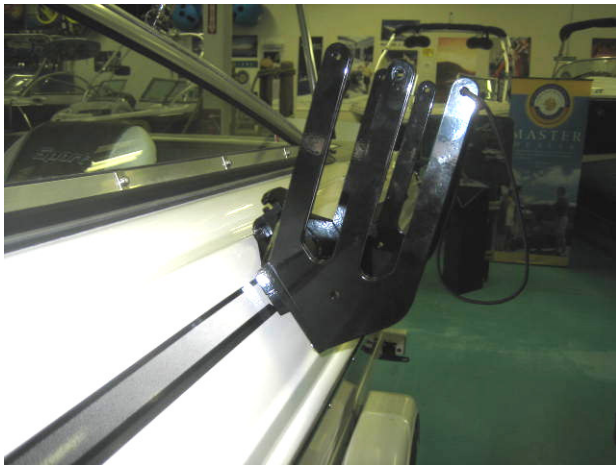

Top Mount Cleat

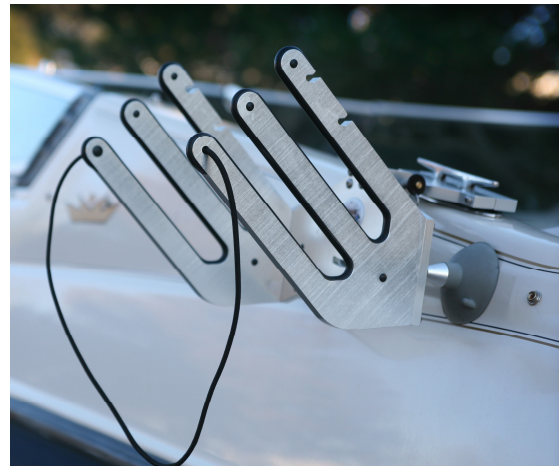

Due to the natural vibration of driving your boat and general use, all screws should be checked before use to ensure they are tight. Failure to do so will void any warranty.

Problems with Securing the Rack

It is possible that with many different boat manufacturers, models, and years, that the rack may not properly fit your boat. LCW has designed the Overboard system to work with most boats, but if you find that the rack does not securely attach to your boat, avoid using the rack and feel free to make use of our return policy. We advise that you first call (402) 690-2341 to discuss your mounting problems. Our return policy is for full refund (minus shipping) if returned within 30 days of the purchase without any visible damages or missing parts.

Care and Appearance

You can maintain the new appearance of your racks by wiping with a clean damp cloth after each use. Soapy water, car wax or a marine spot remover can also be used as needed.

Rack Installation Instructions and Owners Manual

Thank you for your purchase of the Overboard Rack System. If you are not completely satisfied with your rack, please contact us at: sales@liquidcouragewatersports.com. Prior to installation, please take a few minutes to review the instructions for proper, secure installation. ***Failure to comply with these instructions may result in personal injury or property damage for which Liquid Courage Watersports will not be liable.***

Each rack has a wide variety of adjustment capabilities to make the rack versatile on nearly any boat.

- Prior to trailering, verify that your trailer has adequate clearance for your rack, in particular with boat guide ons. If not, you must remove the rack to avoid any damage. Do not trailer your boat with watersports equipment (wakeboards, skis, kneeboards, etc.) in racks.
- Equipment/Boards are not to be held in racks if boat speeds are in excess of 35 MPH, or in rough water situations.
- Rack is not to be used in any manner for docking the boat or securing it to any other object.
- Depending upon the mounting location you choose for your rack, turning the boat too sharply may cause ski/wakeboard ropes to catch on and damage your rack or equipment. All drivers must be aware of this possibility and pay attention to the rope during turns to avoid turning too sharply.
- Clearance between the water and rack system/boards should be checked prior to use. You should also ensure that the racks/boards will not contact the water when driving through boat wake or choppy water. This is very unlikely, but LCW will not be responsible for damage occurring from the racks/boards coming in contact with the water.
- Do not stand or hang on the rack as it can bend the rack or forks or cause damage to the boat and this abuse if not covered under the warranty.
- Do not mount the rack in an area that will create a blind spot for the boat driver.
- Suction cups can fail or loosen over time, depending on the environment they are exposed to (extreme heat, freezing temperatures, salt water). Be sure that rack assembly is secured on the boat to prevent turning or bouncing of the rack or equipment against the boat. Test this by giving the rack an outward pull each time before use. If the suction cups become damaged or deteriorated and do not hold securely to the boat, avoid using the rack and contact Liquid Courage Watersports to purchase replacement suction cups, or order online.
- To prevent screws from seizing, it is recommended that you use an anti-seize solution in the screw holes prior to assembly. This is available at many auto-parts stores or hardware stores.

Liquid Courage Watersports Warranty

Liquid Courage Watersports warrants this product will be free from defects in materials and workmanship for a period of one (1) year from the date of purchase. This Limited Warranty does not cover lost parts or product surfaces, as their care cannot be controlled by the manufacturer, nor does it cover any damage sustained as a result of any modification, improper installation, or improper use of the product not previously approved in writing by Liquid Courage. Liquid Courage's liability under this Limited Warranty shall be limited to the cost of repair or replacement of the defective goods. TO THE FULLEST EXTENT PERMITTED BY LAW, LIQUID COURAGE SHALL NOT BE LIABLE FOR ANY CONSEQUENTIAL OR INCIDENTAL DAMAGES, INCLUDING, BUT IN NO WAY LIMITED TO, DAMAGE TO BOATS OR OTHER PERSONAL PROPERTY, TRANSPORTATION CHARGES, OR COSTS OF INSTALLATION OR REMOVAL OF THE PRODUCT. Defects must be reported within 30 days of discovery and parts must be returned in order for this Limited Warranty to remain in effect. If you need to make a warranty claim, contact Liquid Courage at support@liquidcouragewatersports.com to request a return authorization number which is required for all claims. This Limited Warranty gives you specific legal rights, and you may also have other rights which vary from state to state. Some states do not allow the exclusion or limitation of incidental or consequential damages, so the above limitations or exclusions may not apply to you.

